



Installer and user reference guide

Daikin Altherma user interface used as room thermostat

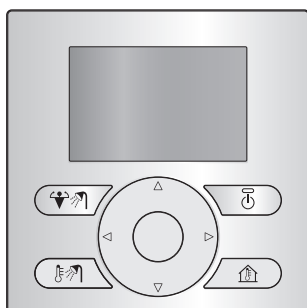

Table of Contents

For the user	2
1 Buttons	2

2 Status icons	2
For the installer	3
3 Overview: Installation and configuration	3
4 To connect the user interface used as a room thermostat	3

For the user

1 Buttons



NOTICE

If the buttons on the user interface used as room thermostat don't respond, check the user interface connected to the indoor unit for holiday mode. Turn holiday mode off to enable buttons on the user interface used as room thermostat.

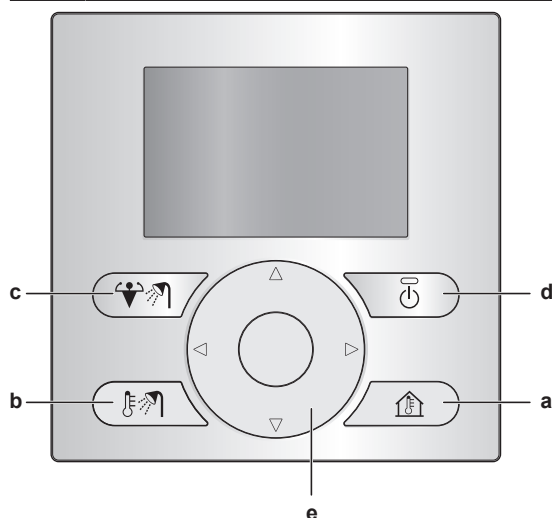

- a** **SPACE HEATING/COOLING CONTROL**
Go to the room temperature home page, where you can:
 - Read out the actual room temperature.
 - Press or to adjust the desired room temperature.
 - Press to turn ON or OFF the room temperature control.
- b** **DOMESTIC HOT WATER CONTROL**
Go to the domestic hot water home page, where you can:
 - Read out the actual domestic hot water tank temperature (only if the system contains a domestic hot water tank).
 - Read out the desired instant domestic hot water temperature (only in case of instant domestic hot water production by a boiler).
 - Press to turn ON or OFF the domestic hot water control.
- c** **ACTIVATE DHW TANK BOOSTER MODE**
Activate the DHW tank booster mode (only if the system contains a domestic hot water tank, and provided that the domestic hot water control is turned ON).
- d** **ON/OFF**
Turn ON or OFF the space heating/cooling or domestic hot water control (on the respective home pages).
- e** **NAVIGATION BUTTONS**
On the room temperature home page, adjust the desired room temperature .

2 Status icons

Icon	Description
	Space operation mode = Heating.
	Space operation mode = Cooling.
	Domestic hot water operation.
	The DHW tank booster mode is active.
	Unit is operating.
	Actual temperature.
	Desired temperature.
	A malfunction occurred.

If is displayed, check the user interface connected to the indoor unit for more information or, if necessary, contact your installer.

For the installer

3 Overview: Installation and configuration

Installation

- The user interface in the indoor unit acts as control center.
- The user interface used as a room thermostat needs to be installed in the room that you want to control.

4 To connect the user interface used as a room thermostat

- 1 Connect the cable of the user interface used as a room thermostat to the indoor unit.

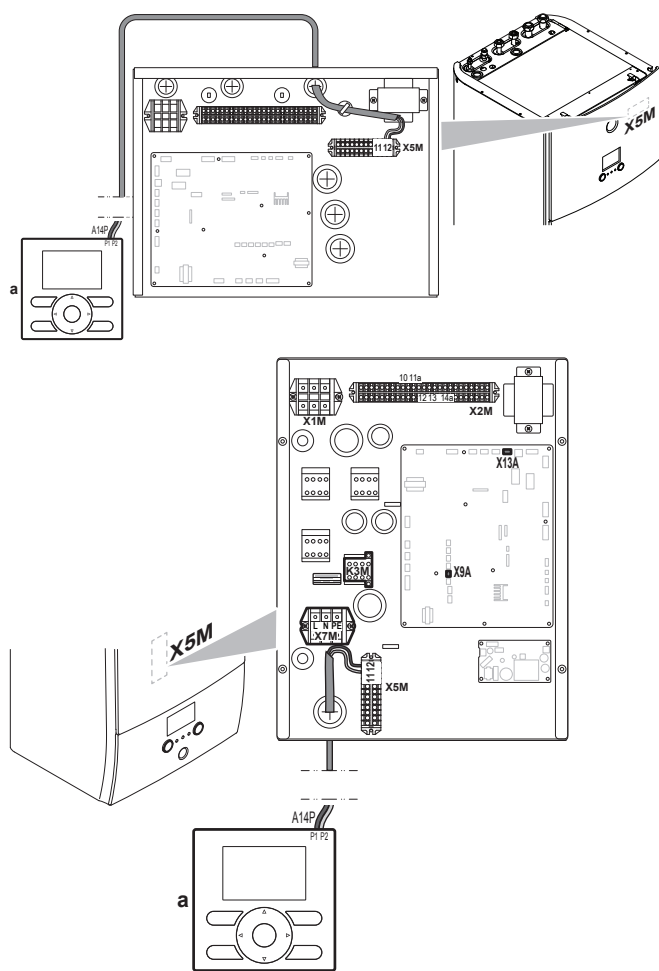

a User interface used as a room thermostat

- 2 Fix the cable with cable ties to the cable tie mountings.

ERC

Copyright 2017 Daikin

DAIKIN EUROPE N.V.

Zandvoordestraat 300, B-8400 Oostende, Belgium

4P500350-1A 2017.12